

HydroWhirl® Stinger



(HWS2) Reactionary Force Slotted Spray Nozzle



DESIGN FEATURES

- Patent-pending no-weld design eliminates weak points and uneven surfaces
- Bearing assembly is centered within the spray head for improved balance and spray propagation
- Compact size with industry-leading flow rates fits 3/4"-2" tri-clamp openings
- Better spray uniformity can be maintained at lower pressures
- Unique patent-pending pipe thread technology flushes to reduce contamination and bacteria growth
- Zirconia ceramic bearings for long service life and extreme chemical resistance
- 32Ra surface finish ideal for sanitary applications

SPRAY CHARACTERISTICS

- Vigorous spray action
- Optimum cleaning performance @ 40psi

Spray Angles: Complete 360° spray coverage

Flow Rates: 1.1 to 102 GPM

Max Temperature: 200°F/93°C

Filtration:

- Line strainer with a mesh size 0.004 in/150 mesh for HWS2-4 and smaller
- Line strainer with a mesh size 0.003 in/200 mesh for HWS2-7.5 and larger

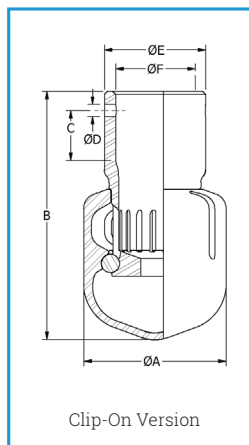
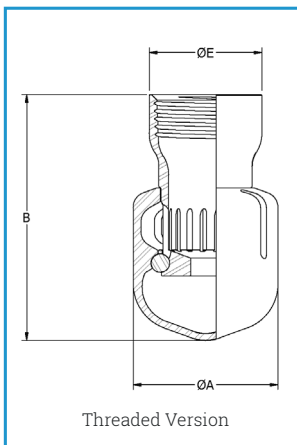

DIMENSIONS IN INCHES (CLIP-ON)

Tube Size	A	B	C	D	E	F	Weight (oz)	Min Tank Entry Dia
1"	1.85	3.40	0.85	0.156	1.32	1.00	12	1.85
3/4"	1.35	2.84	0.49	0.086	1.06	0.75	7	1.35
1/2"	0.85	1.91	0.50	0.086	0.84	0.50	3	1.19
3/8"	0.60	1.38	0.34	0.086	0.56	0.38	0.8	0.90

DIMENSIONS IN INCHES (THREADED)

Pipe Size	A	B	E	Weight (oz)	Min Tank Entry Dia
1"	1.85	3.13	1.44	10.5	1.85
3/4"	1.35	2.75	1.15	5.2	1.35
1/2"	1.35	2.38	0.95	4.7	1.35
3/8"	0.85	1.81	0.75	1.4	0.85
1/8"	0.60	1.25	0.50	1	0.60

HYDROWHIRL® STINGER FLOW RATES

Materials: 316L Stainless Steel Body, Ceramic Bearings

Female Connection Type	Nozzle Number	Spray Angles	Flow Rate (GPM) @ Differential Pressure (psi)						Maximum Free Passage	Coverage Dia @ 40 psi
			10	20	30	40	50	60		
			psi	psi	psi	psi	psi	psi		
1/8" FNPT, BSP 3/8" Tube Clip-On	HWS2-2.1	360°	1.09	1.51	1.83	2.10	2.33	2.54	.025	2
	HWS2-4		2.05	2.86	3.48	4.00	4.46	4.87	.039	7
	HWS2-7.5		3.84	5.37	6.53	7.50	8.35	9.12	.063	7
3/8" FNPT, BSP 1/2" Tube Clip-On	HWS2-10	360°	4.94	7.03	8.64	10.0	11.2	12.3	.024	8
	HWS2-12		6.22	8.64	10.5	12.0	13.3	14.5	.039	10
	HWS2-17		8.59	12.1	14.8	17.0	19.0	20.8	.079	10
1/2" FNPT, BSP	HWS2-20	360°	10.2	14.3	17.4	20.0	22.3	24.3	.039	10
	HWS2-26		12.9	18.3	22.5	26.0	29.1	31.9	.064	10
3/4" FNPT, BSP 3/4" Tube Clip-On	HWS2-20	360°	10.2	14.3	17.4	20.0	22.3	24.3	.039	10
	HWS2-26		12.9	18.3	22.5	26.0	29.1	31.9	.064	10
1" FNPT, BSP 1" Tube Clip-On	HWS2-33	360°	16.6	23.4	28.6	33.0	36.8	40.3	.031	11
	HWS2-55		27.6	39.0	47.7	55.0	61.5	67.3	.064	12
	HWS2-66		33.4	46.9	57.3	66.0	73.7	80.6	.094	12
	HWS2-84		43.2	60.2	73.2	84.0	93.5	102	.125	12

Flow rates represent threaded connections with a 360° spray angle.

Flow rates may vary for other connection types and spray angles.